



I-285 Express Lanes Transit

Quarterly CID Briefing

November 7, 2024



AGENDA

1

Study
Updates

2

Recap:
Service
Planning
Approach

3

Scenario
Development

4

Station
Concepts

5

Public
Involvement
Updates

6

Next
Steps

Study Progress

What have we been doing?

-  Scenario Development
-  Hybrid Alternative Analysis
-  Station Design & Development
-  Public Engagement

Service Planning Approach



Informs
**Infrastructure
Investments**



Drives
**Design
Decisions**

Infrastructure Investment Tiers

Tier 1 - At/On I-285

Station Type (Inline, Offline, Circulator)

Station Location

Managed Lane Access (Proposed or New Entry Points)

Tier 2 - Off I-285

Transit Supportive Treatments (Exclusive Bus Lanes, Queue Jumps, Transit Signal Priority)

Scenario Development



Service Planning Approach and Scenario Development

2022
Stop-to-Stop
Service

Scenario 1
Perimeter Express
Riders (Baseline)

Scenario 2
Essential Riders

Scenario 3
Commuters

Hybrid
Alternatives

Preferred
Alternative

Service Planning Approach - Three Scenarios

Perimeter Express Riders

Distance from I-285



Why they ride?

Speed, Convenience, limited stops

Who is the focus?

I-285 adjacent travelers

Trip types

All-day: Express trips along I-285

Access mode



Essential Riders



1-5 miles

Necessity and affordability

Cost burdened, transit dependent

All-day: Work, shopping, daily activities



Commuters

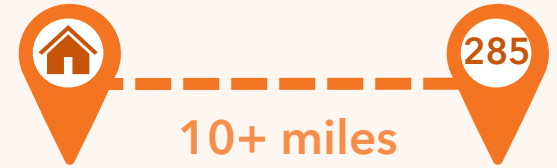

10+ miles

Convenience and cost savings

Higher income, limited telework ability

Peak hours: Work commute





Service Planning Approach and Scenario Development

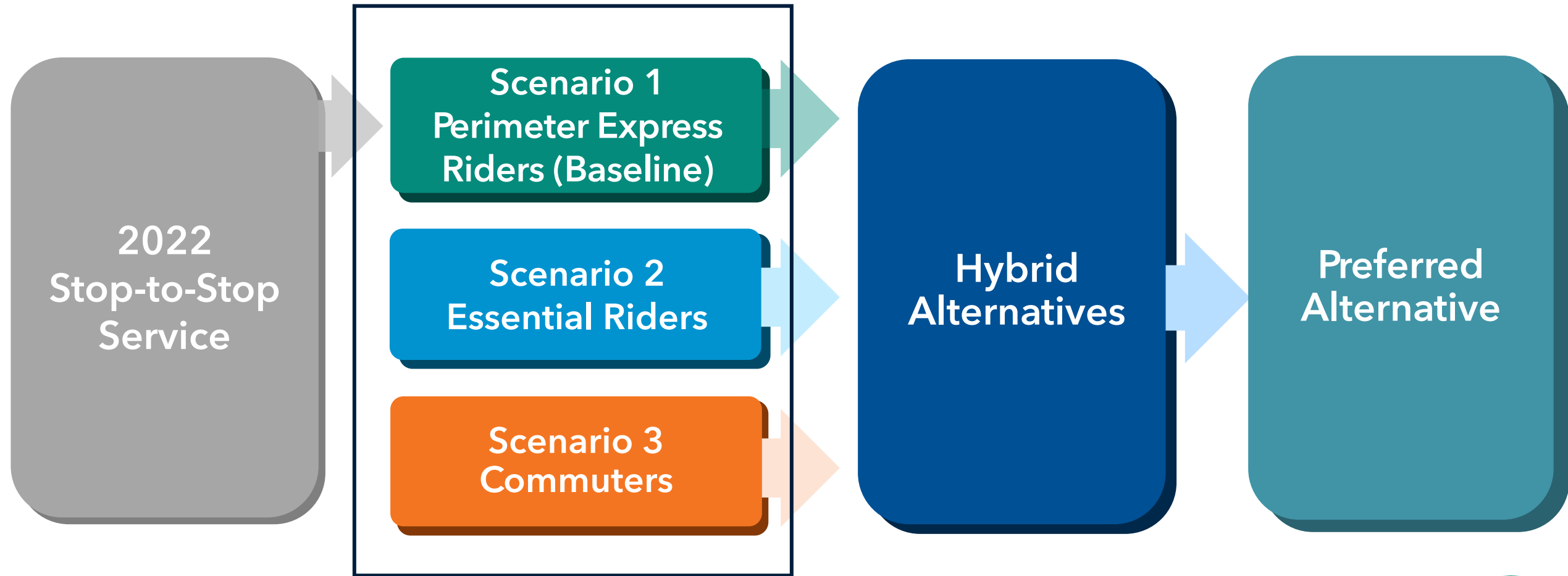



Scenario Planning - Key Findings

Perimeter Center Station

Circulator had greatest ridership

Doraville Station

Offline station had the highest ridership

Northlake Station

Performed better as offline at mall

Memorial Drive Station

Not advanced based on proximity to Indian Creek

Low Demand Stations

- Cumberland Parkway
- Shallowford Road

Connections to adjacent services

Stations south of I-20 should be included

- Greenbriar Transit Hub
- South DeKalb Transit Hub



Service Planning Approach and Scenario Development

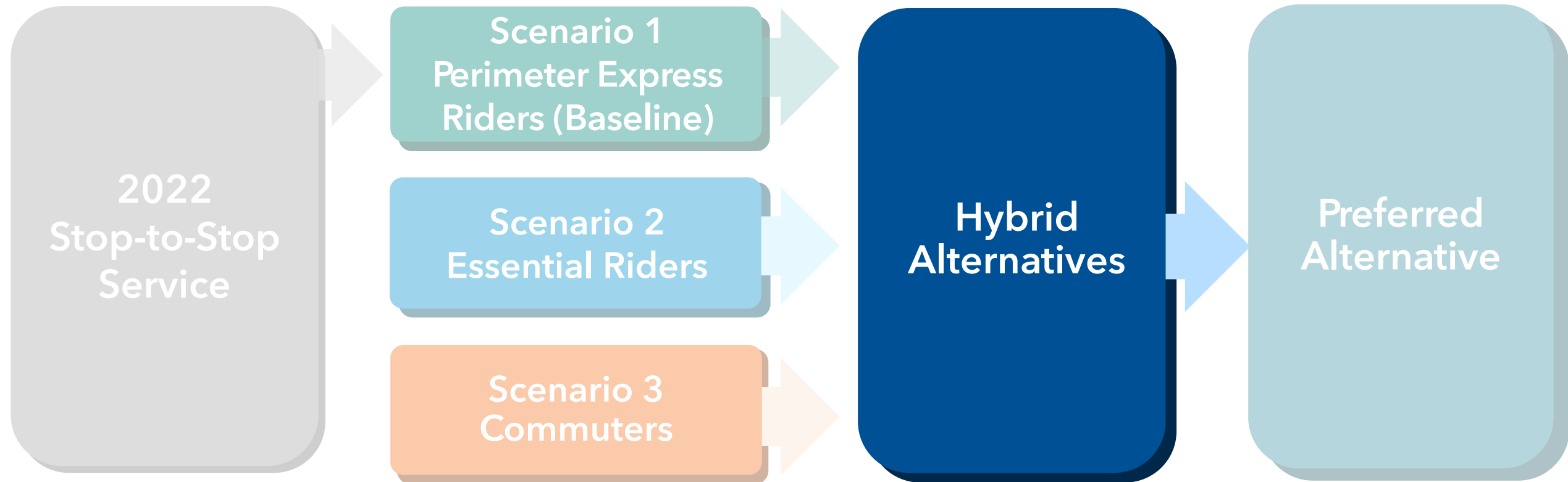



Initial Hybrid Alternative Considerations

- 1 Best-performing routes/stop types from individual scenarios
- 2 Prioritized one-seat trips
- 3 Maximized accessibility

Hybrid Alternative 1 Summary - Stations

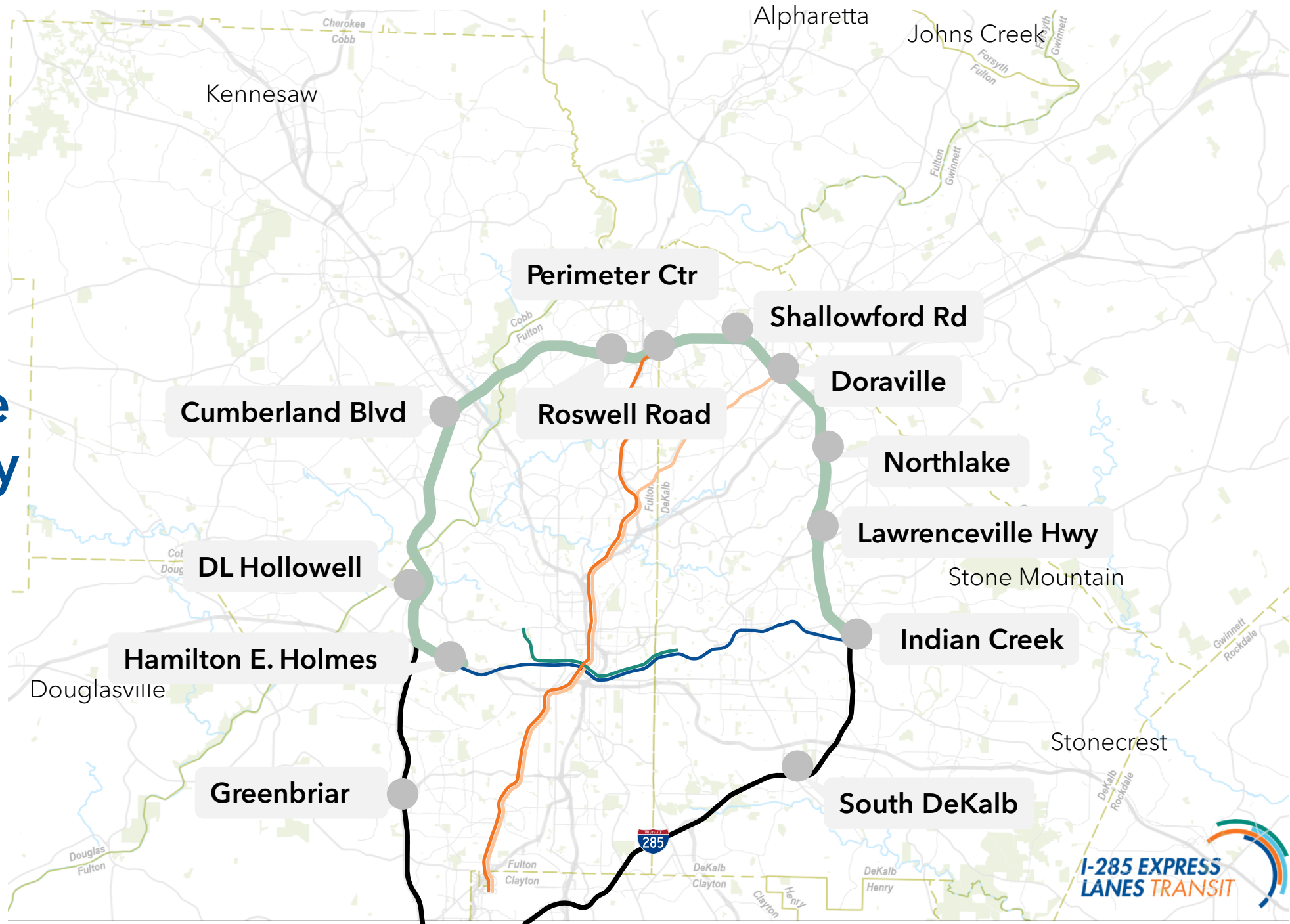

Hybrid Alternative 1 Routes

Essential Rider

- E1 
- E2 
- E3 
- E4 
- E6 
- W6 
- W7 

Stations/Stops

- I-285 
- Essential Rider/Commuter 

Commuter

- C2 
- C3 
- C5 
- C8 
- C11 
- C12 

MARTA Rail Lines

- Blue 
- Gold 
- Green 
- Red 

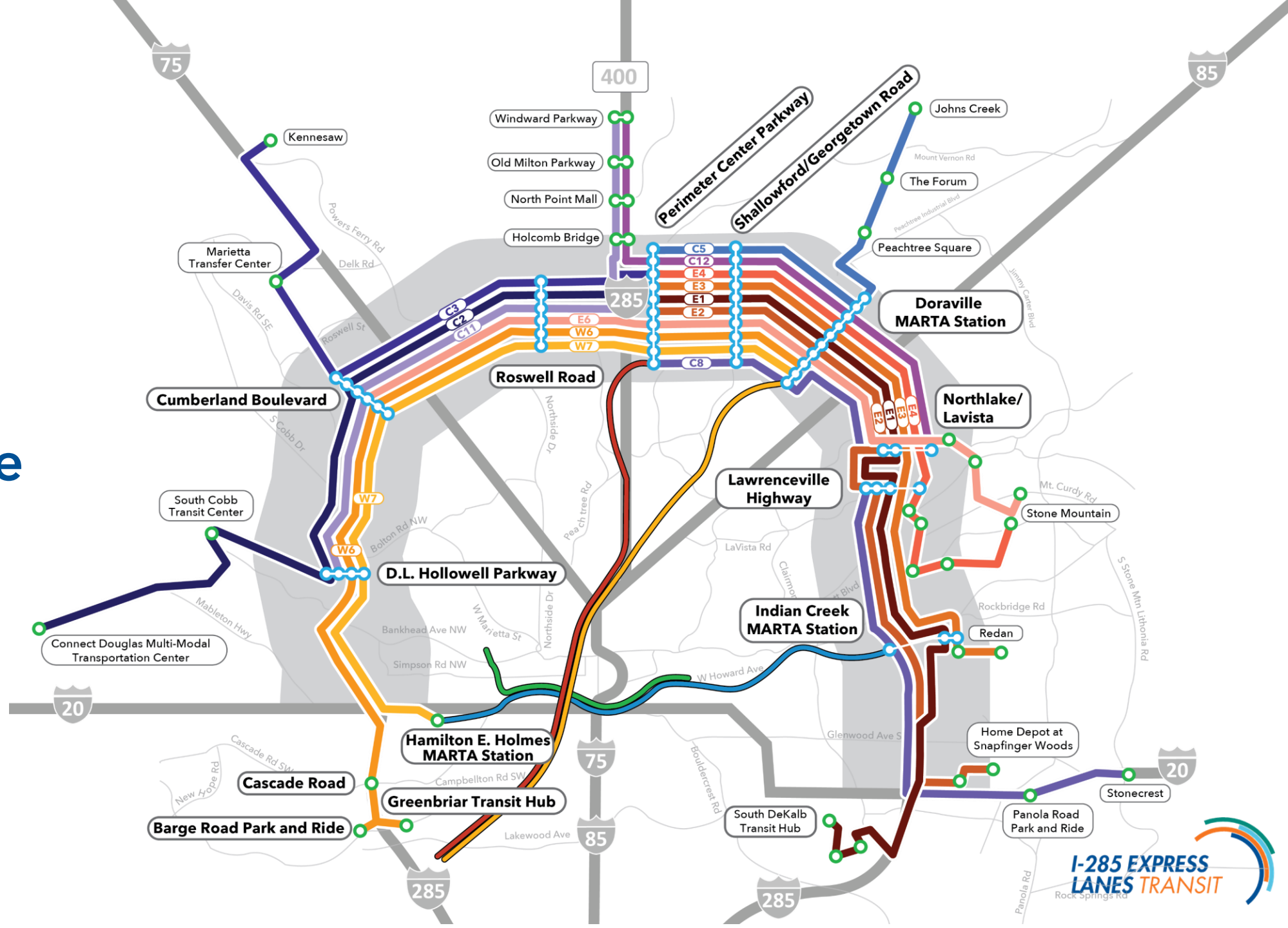



Core Metrics



Demand



**Accessibility
to Jobs**



**Accessibility
for People**

Hybrid Alternative 1 - Stats



Total boardings **13,547**

New boardings **6,711**
(riders shifting from auto to transit)



Total jobs **204,553**

Essential jobs **108,790**



Total zero-car households **4,223**

% of trips from zero-car households **38%**



Population **129,066**

Hybrid Alternative 1 Summary

Core Metrics



	Demand		Accessibility for People		Accessibility to Jobs	
	Boardings	New Boardings	Population	Zero car Households	Essential Jobs	Total Jobs
Future Baseline (2050) Stop-to-Stop/Perimeter Express	5,733	2,549	17,737	770	17,347	34,080
Future Hybrid 1 (2050)	13,547 (136%)	6,711 (163%)	129,066 (628%)	4,223 (448%)	108,790 (527%)	204,553 (500%)

Hybrid Alternative 1 Summary - Stations

- High Boarding/Demand
- ★ Medium Boarding/Demand
- ▲ Low Boarding/Demand

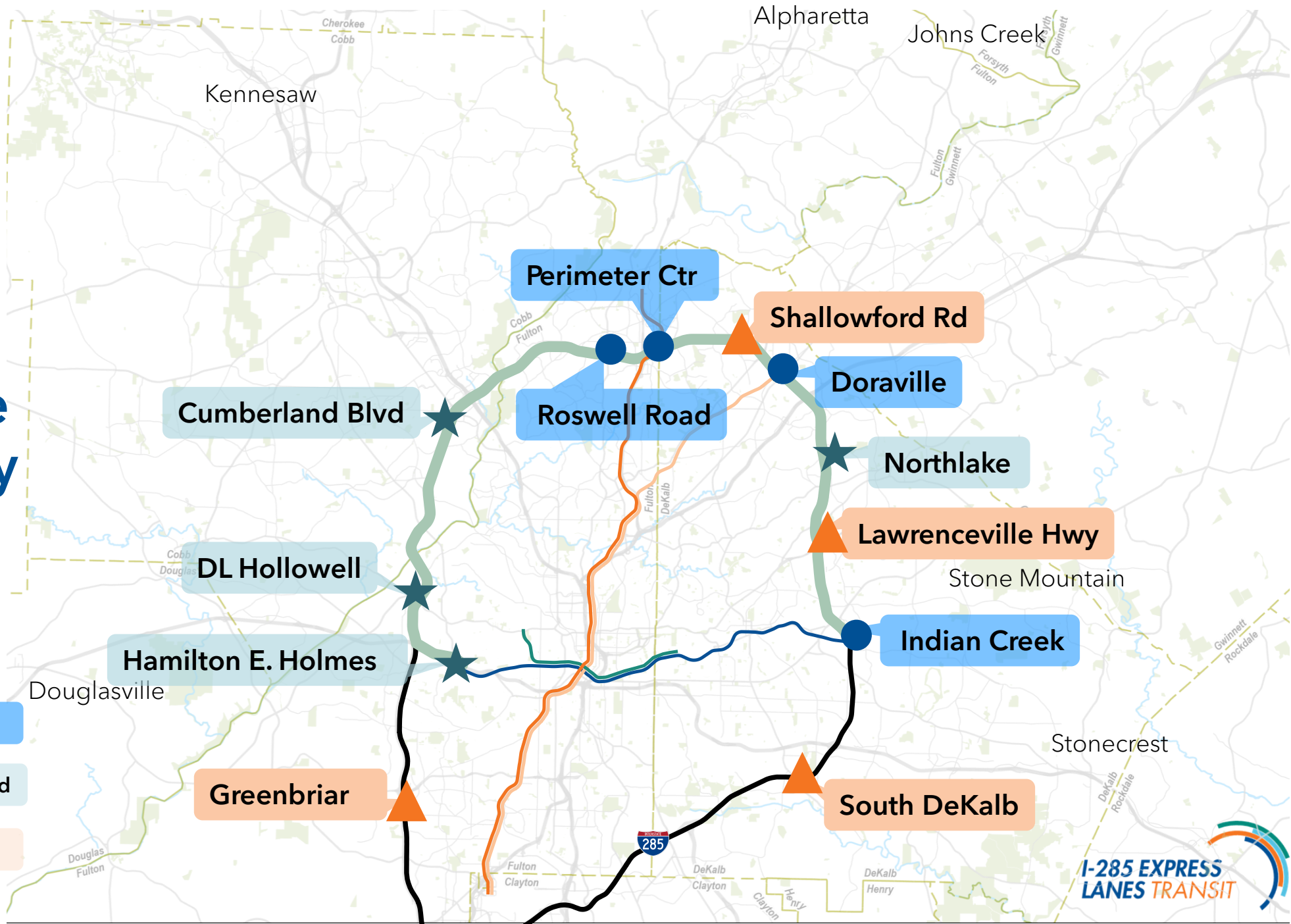

Station Concepts



Station Concepts

Shown in Previous Meetings

- Perimeter Center Parkway
 - Inline
 - Offline
 - Circulator
- Roswell Road
 - Inline
 - Offline
- Cumberland Boulevard
- Doraville
- Indian Creek

What we're showing today

- Lawrenceville Highway
- Northlake Parkway
 - Inline
 - Offline
- Shallowford Road
- Cumberland Parkway
 - Inline
 - Offline
- DL Hollowell Parkway
- Hamilton E. Holmes

Lawrenceville Highway (Inline)

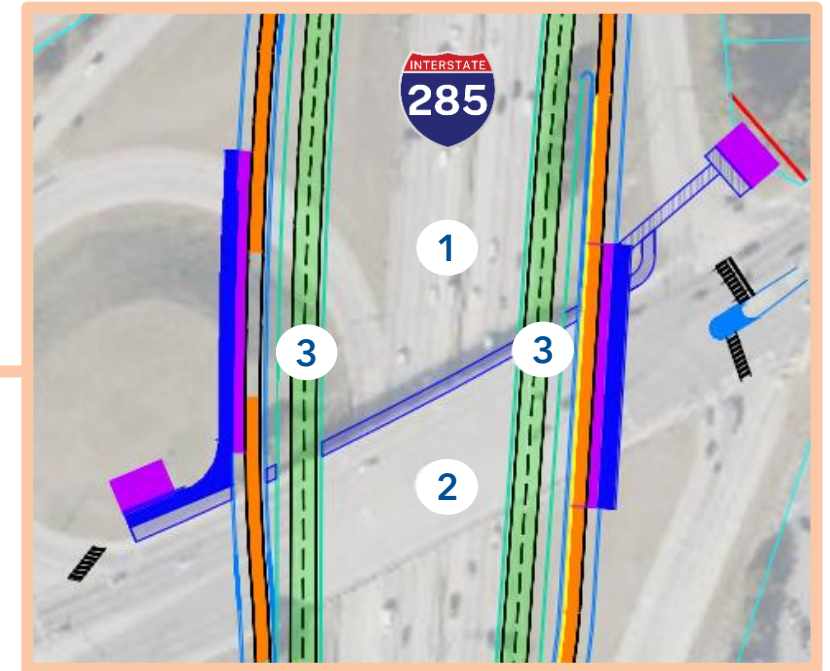
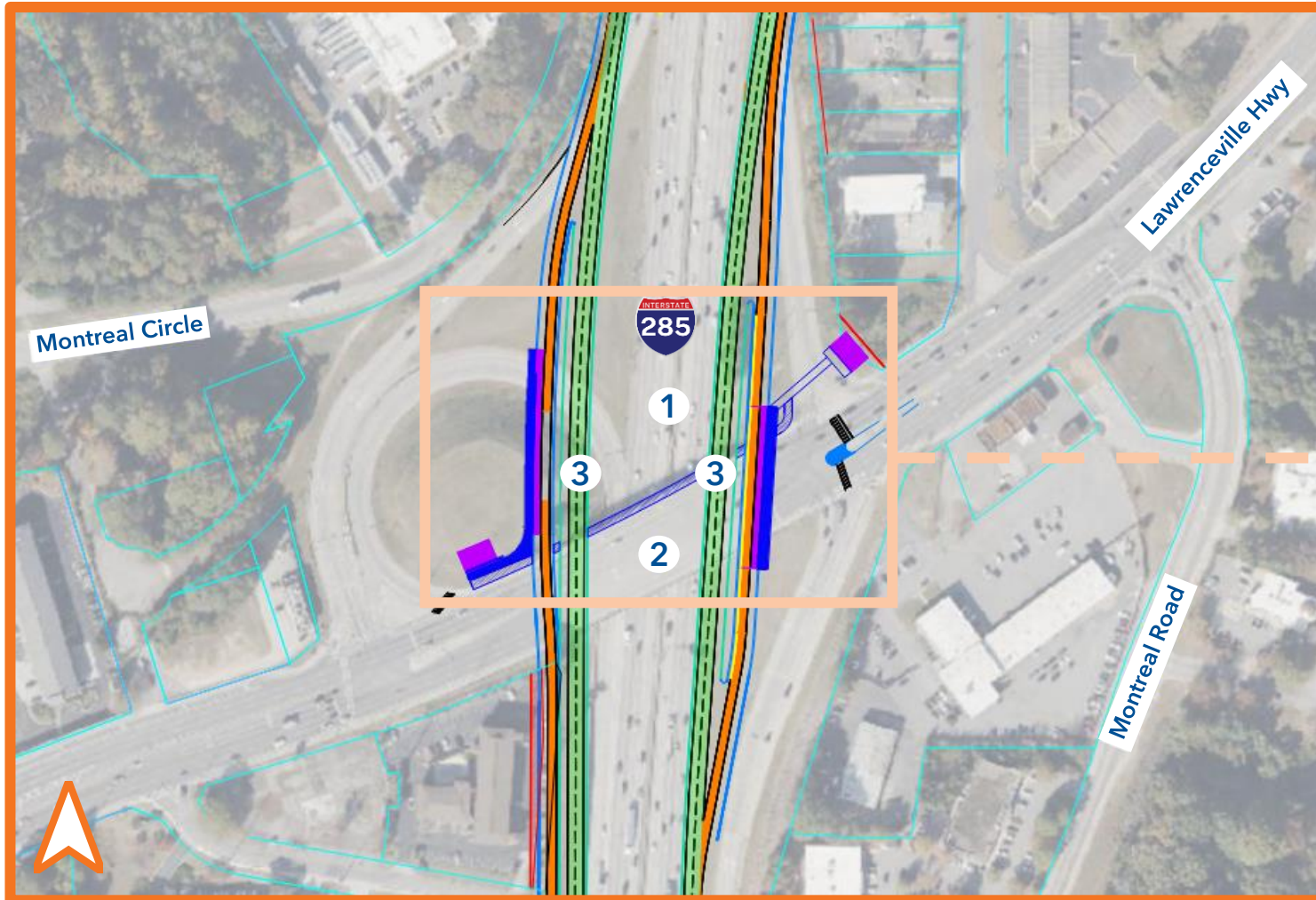

Northlake Parkway (Inline)

NOTE:

Bus rapid buses in bus only lane should get advance green signal indication to precede motor vehicles across intersection.

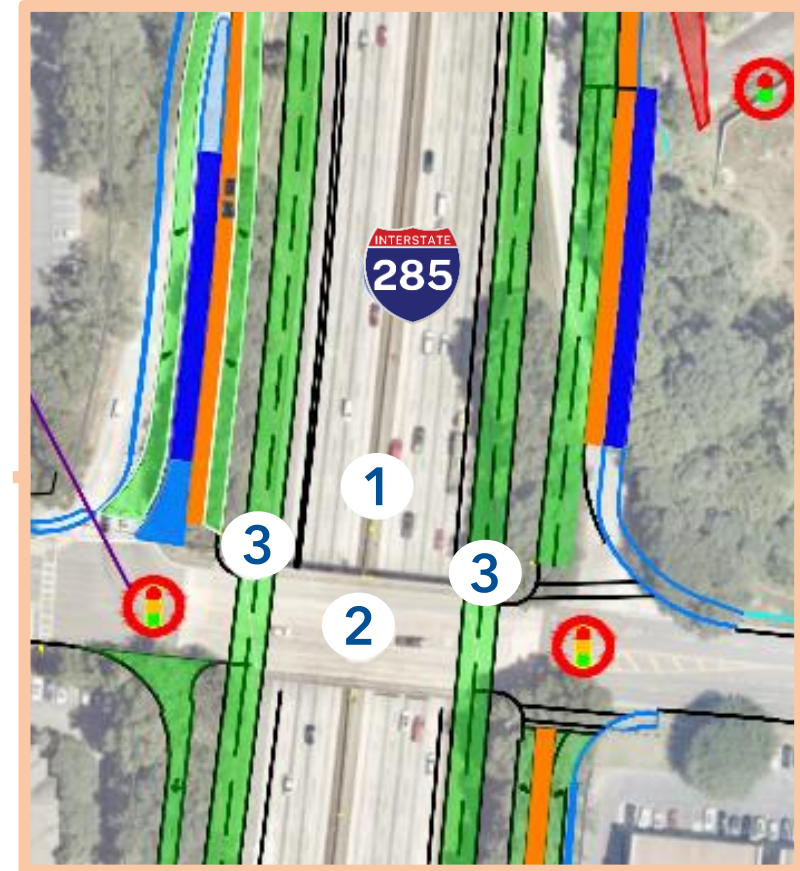
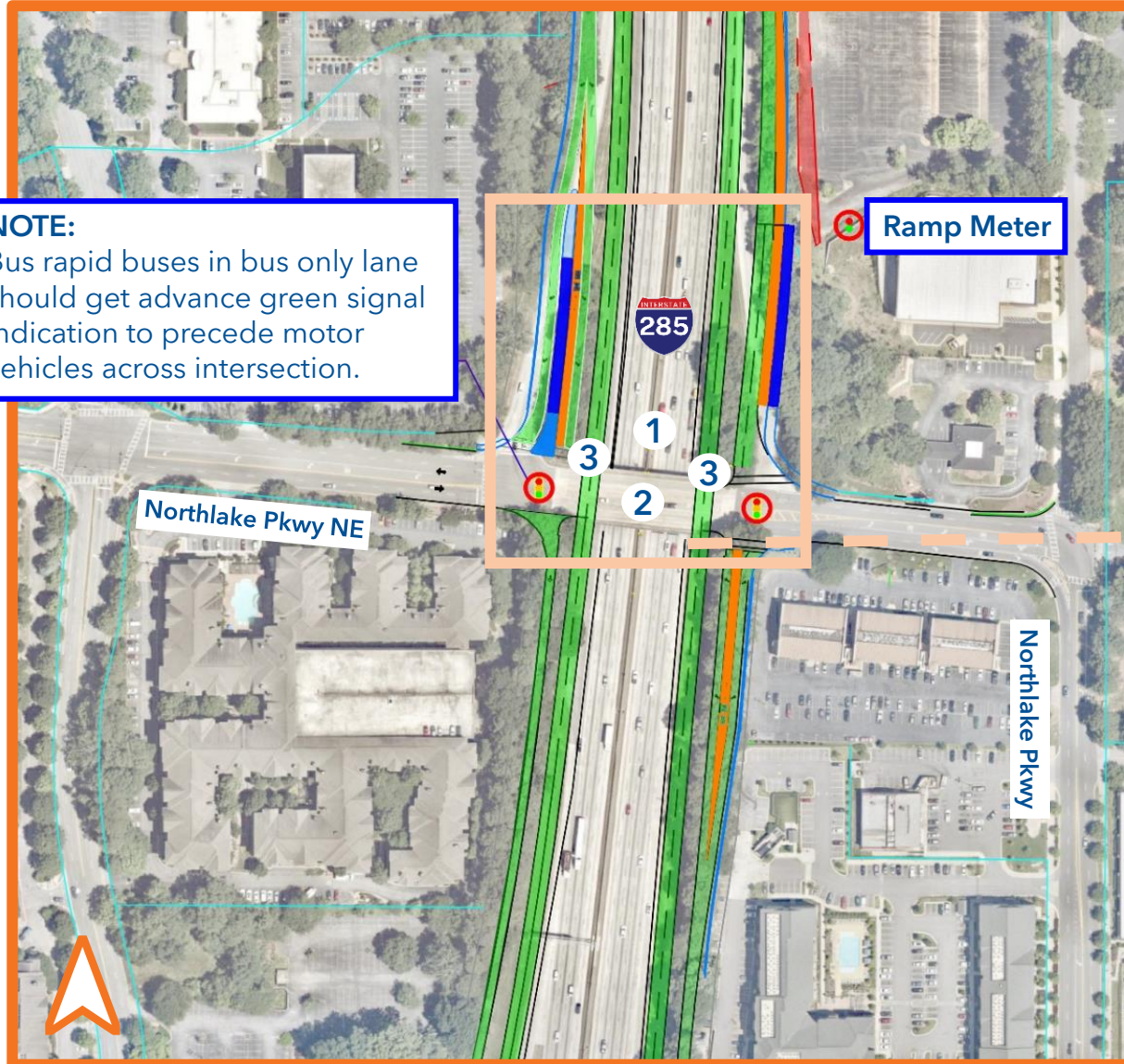

Northlake (Offline)



Shallowford Road (Inline)

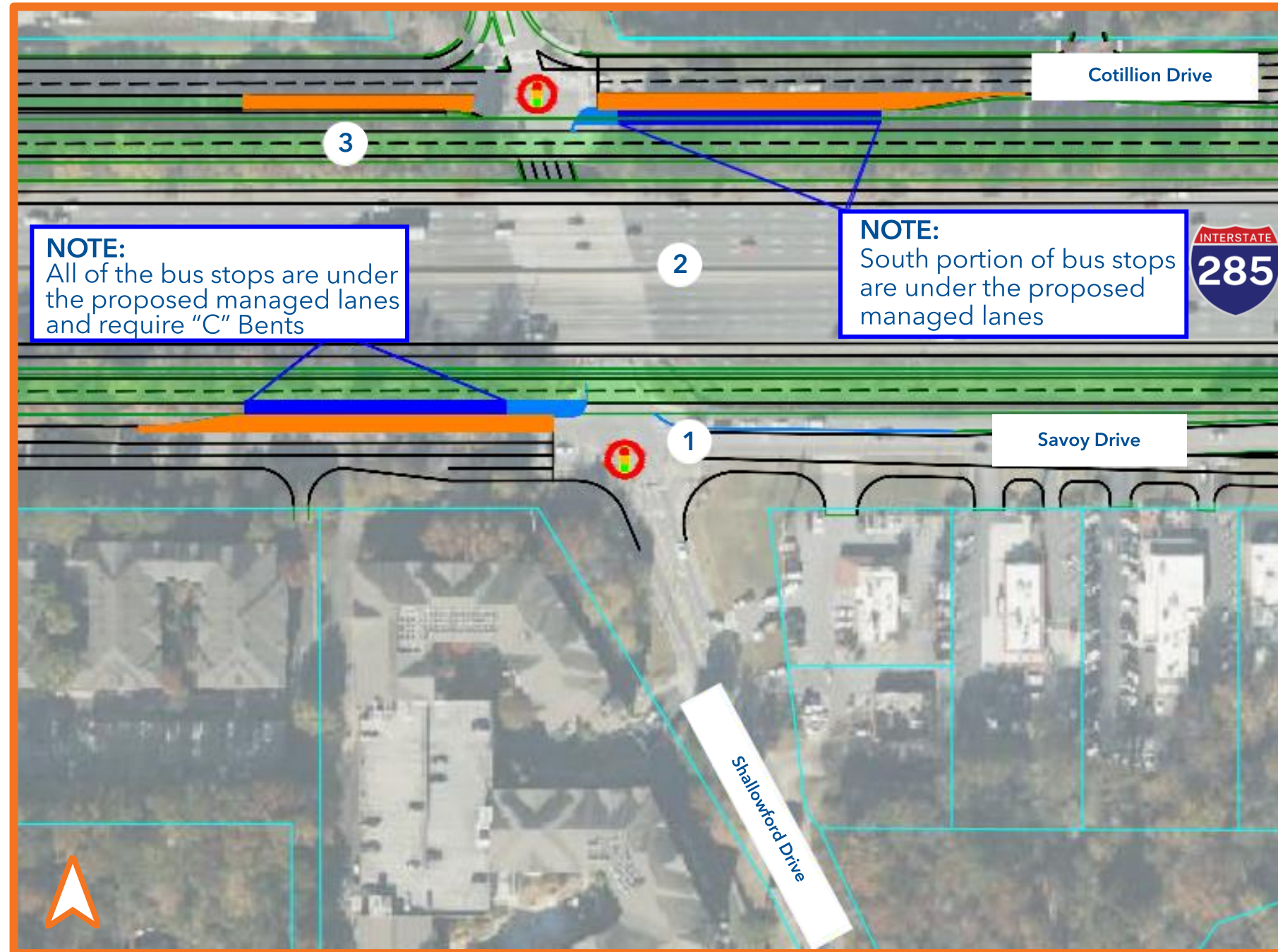

Cumberland Parkway (Inline)



Cumberland Parkway (Offline)



DL Hollowell Parkway (Inline)



Hamilton E Holmes (Offline)



What's Next? Develop Hybrid Scenario 2

Hybrid Alternative 2 - Stations

- High Boarding/Demand
- ★ Medium Boarding/Demand
- ▲ Low Boarding/Demand

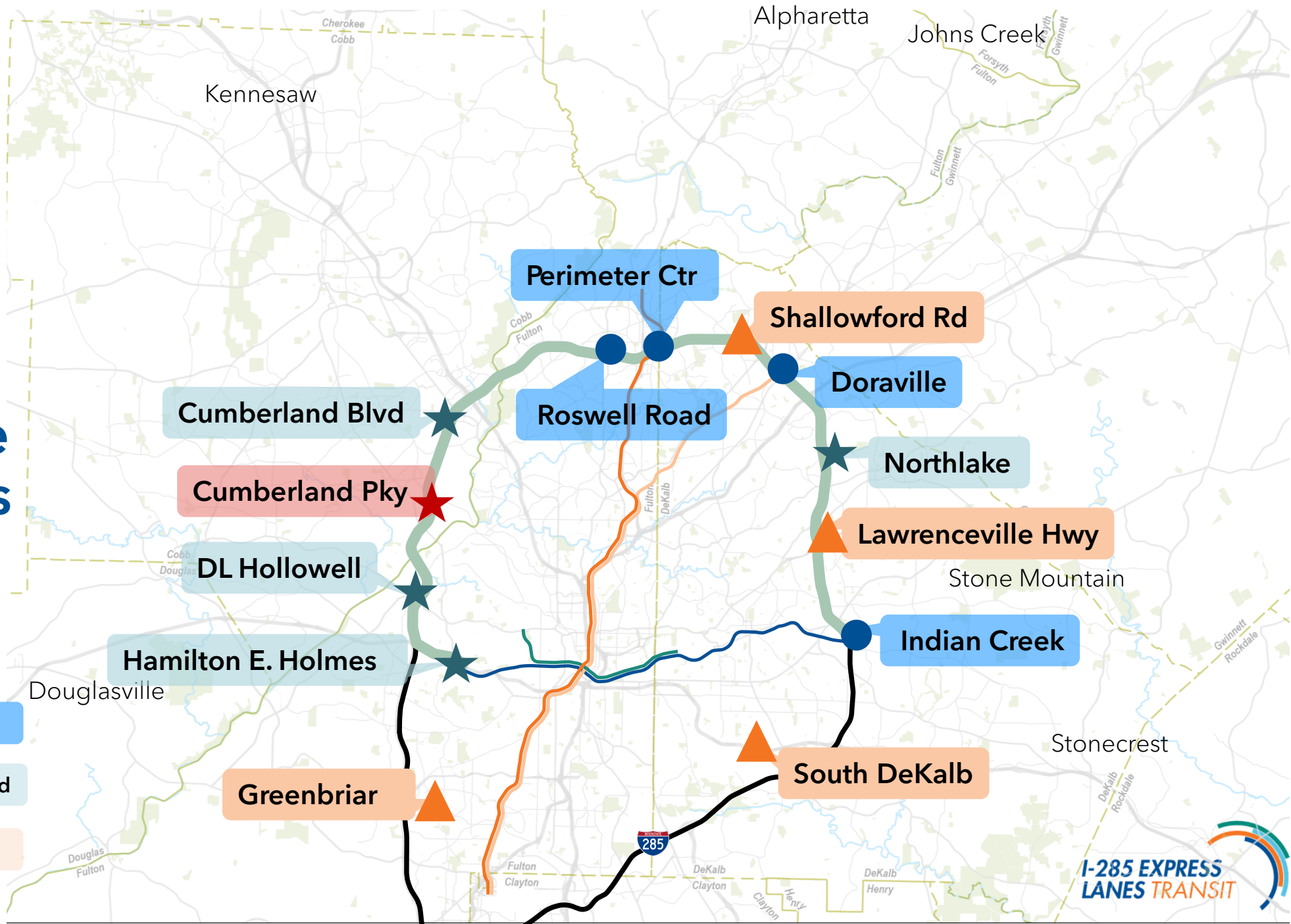

Public Involvement Updates

Engaging the Community



Virtual Engagement
(1180+ Survey Responses,
Social Media Campaign)



15
Community
Pop-Up Events



12
Stakeholder Interviews



Public Involvement Offices,
Municipal Meetings
CID Meetings

SURVEY RESULTS



OPEN

JUNE - AUGUST 2024



TOTAL RESPONSES

1180



TOP ZIP CODE

30338

Dunwoody



WHAT ISSUES DO TRAVELERS FACE ON I-285?

Heavy Traffic

88%

Lack of Connections

52%

Safety Concerns

43%

Low Time Reliability

42%



DO PEOPLE USE TRANSIT?

47%

Occasionally use transit

31%

Regularly use transit

22%

Do not use transit



WHAT COULD ENCOURAGE TRANSIT USE



Time savings (54%)



More options (45%)



Convenient locations (42%)



WHERE ARE PEOPLE GOING?

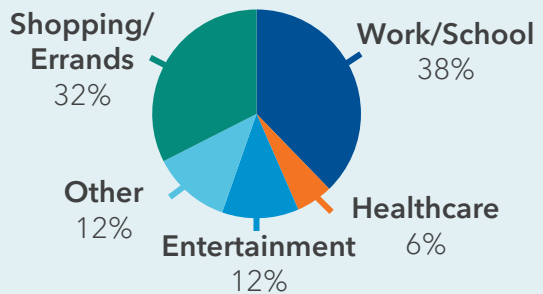

WHY PEOPLE DON'T USE TRANSIT

61% - Destination not served

51% - Prefer Driving

45% - Takes too long

Public Meetings



Wednesday, December 4, 2024

 **5:30 - 7:30 pm**

 **Smyrna Community Center**
1250 Powder Springs St.
Smyrna, GA 30080
Translators will be available in Spanish and Arabic

Thursday, December 5, 2024

 **11:00 am - 1:00 pm**

 **Hampton Inn Perimeter Center**
769 Hammond Dr. NE
Atlanta, GA 30328
Translators will be available in Spanish and Arabic

 **5:30 - 7:30 pm**

 **Clarkston Community Center**
3701 College Ave.
Clarkston, GA 30021
Translators will be available in Spanish, Arabic, Swahili, and Vietnamese

Next Steps

Schedule

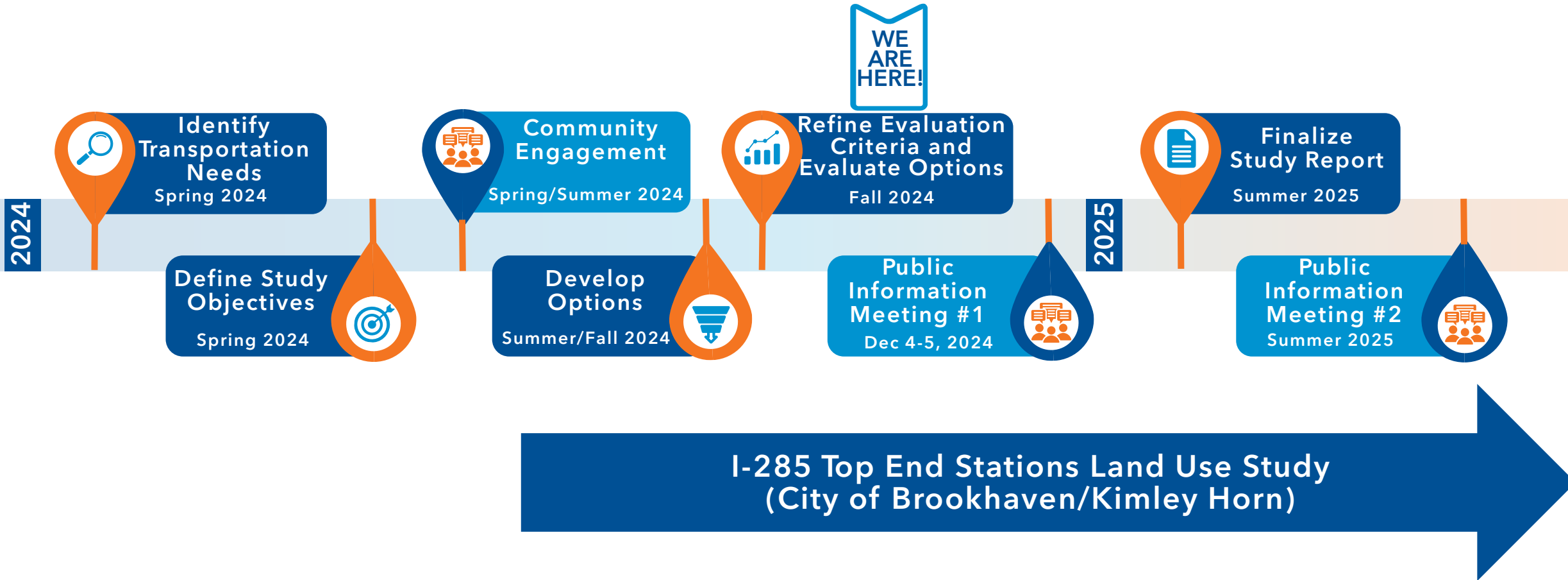

Future Timeline





Questions/Discussion



Stay InInvolved!



Scan to sign up for updates



www.i285ExpressLanesTransit.com

Thank you!